



- Waldorf Water/Sand Unit:**
- Water Pump
  - Water Gutters
  - Drain Plugs
  - Water Tube with carved fish
  - Water Wheel
  - Water Trough
  - Sand Table with Roundabout Distributor
  - Baking Tables
  - Sensory & Texture

Waldorf Water/Sand Play



Daisy Springer



Spinner Bowl



5 Way Swing



Supernova



Baking Table



Basket Swing



Boulders



Sleepers



Seesaw

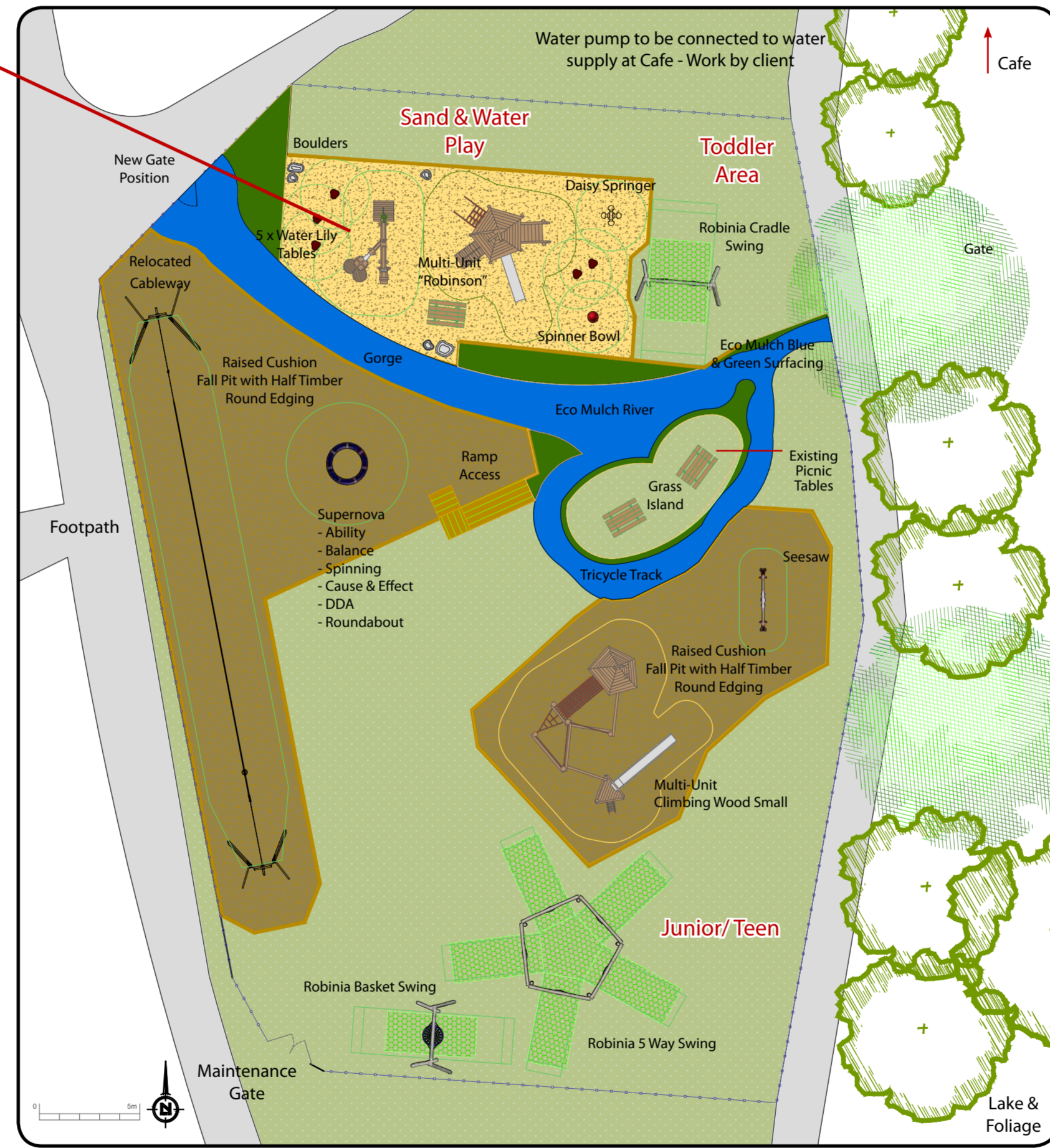

Climbing Wood Small Multi-Play Unit



Robinson Multi-Play Unit



**Charlton Lakes Play Area**



\*NOTES: The exact location of the equipment is to be agreed by the client. This layout is indicative only - the order confirmation document contains the finite information about the proposed area. On successful award of tender - Full site survey will be required prior to installation. DO NOT SCALE THIS PLAN.

This drawing is not based on a detailed site survey and thus precise location and orientation of equipment may vary to suit ground conditions and client preferences. Client to cover connection to water pump from water supply at Cafe.

KOMPAN is a registered member of the Association of Play Industries.



KOMPAN's quality and environmental procedures are certified according to ISO9001/ ISO14001/BS7750.



STANDARDS AND COMPLIANCE: All KOMPAN products are independently tested to EN1176 by TÜV Testing House, Hamburg. All impact absorbing surfacing specified by KOMPAN is tested to EN1177. Certificates available upon request.



PLAN SCALE: 1:200 @ A2  
DRAWING NO.: SQ218017  
DATE: 16/06/2014  
ACCOUNT MANAGER: RP / JR  
DRAWING BY: ML, rev. by ZR



KOMPAN LTD. 21 Roebuck Way, Knowlhill, Milton Keynes MK5 8HL  
Tel: 01908 201 002 Fax: 01908 201 007 email: kompan.uk@kompan.com